

**PERMIT**

**CITY OF NAPOLEON - BUILDING DEPARTMENT**

255 West Riverview Avenue, Napoleon, Ohio 43545 - 419-592-4010

Permit No. 01059 Issued 10JUL85  
date

Job Location 1 Interstate Drive  
address

Lot F Westhoven Industrial Park  
sub-div or legal discript

Issued By Richard G Hayman PEB  
building official

Owner Tippmann And Associates  
name tel.

Address 4410 NEw Haven Ave Fort Wayne IN

Agent Self 423-2452  
builder-eng.-etc. tel.

Address \_\_\_\_\_

Description of Use Cold Storage S-2

Residential \_\_\_\_\_  
no. dwelling units

Commercial \_\_\_\_\_ Industrial I - 1

New Add'n. 30,104 Alter \_\_\_\_\_ Remodel \_\_\_\_\_

Mixed Occupancy \_\_\_\_\_

Change of Occupancy \_\_\_\_\_

Estimated Cost \$ 1.8 Mils

FEE'S	BASE	PLUS	TOTAL
<input checked="" type="checkbox"/> BUILDING	35.00	361.25	396.25
<input checked="" type="checkbox"/> ELECTRICAL	12.00	120.42	132.42
<input type="checkbox"/> PLUMBING			
<input type="checkbox"/> MECHANICAL			
<input type="checkbox"/> DEMOLITION			
<input type="checkbox"/> ZONING			
<input type="checkbox"/> SIGN			
WATER TAP			
SEWER TAP			
TEMP. ELECT.			
ADDITIONAL PLAN REVIEW	Struct. _____ hrs	Elect. _____ hrs	
TOTAL FEES.....			528.67
LESS MIN. FEES PAID _____			-0-
BALANCE DUE.....			528.67

*addition of 14.40 for mech room*

*8/27/85 To BZA for addition*

**ZONING INFORMATION**

district <u>I-1 C1</u>	lot dimensions <u>625a x 289a</u>	area <u>185040.13</u>	front yd <u>60</u>	side yds <u>10</u>	rear yd <u>10</u>
max hgt <u>40</u>	no pkg spaces	no ldg spaces	max cover <u>111,024.08</u>	petition or appeal req'd <u>BZA 5-85</u>	date appr <u>02JUL85</u>

**WORK INFORMATION:**

Size: Length 159-4" Width 189' Stories 1 Ground Floor Area 30,104

Height 28 Building Volume (for demo. permit) \_\_\_\_\_ cu. ft.

Electrical: Entire brief description \_\_\_\_\_

Plumbing: \_\_\_\_\_ brief description \_\_\_\_\_

Mechanical: \_\_\_\_\_ brief description \_\_\_\_\_

Sign: \_\_\_\_\_ Dimensions \_\_\_\_\_ Sign Area JUL 10 1985

Additional Information: 35x40 Bldd for mechanical added to this permit 8/27/85

Date \_\_\_\_\_ Applicant Signature \_\_\_\_\_  
owner-agent

# INSPECTION RECORD

		UNDERGROUND			ROUGH-IN					FINAL		
		Type	Date	By	Type	Date	By	Type	Date	By	Type	Date
<b>PLUMBING</b>		Building Drains			Drainage, Waste & Vent Piping			Indirect Waste			Drainage, Waste & Vent Piping	
		Water Piping			<i>Storm</i>	<i>5/12/85</i>	<i>[Signature]</i>				Backflow Prevention	
		Building Sewer			Water Piping			Condensate Lines			Water Heater	
		Sewer Connection									FINAL APPROVAL	
<b>MECHANICAL</b>		Refrigerant Piping			Refrigerant Piping			Chimney(s)			Grease Exhaust System	
					Duct Furnace(s)			Fire Dampers			Air Cond. Unit(s)	
		Ducts/Plenums			Ducts/Plenums			<input type="checkbox"/> Radiant Htr(s) <input type="checkbox"/> Unit Htr(s)			Refrigeration Equipment	
					Duct Insulation			Pool Heater			Furnace(s)	
					Combustion Products Vents			Ventilation <input type="checkbox"/> Supply <input type="checkbox"/> Exhst.			FINAL APPROVAL	
<b>ELECTRICAL</b>		Conduits & or Cable			Conduits/Cable			<input type="checkbox"/> Range <input type="checkbox"/> Dryer			Temp Service Temp Lighting	
		Grounding & or Bonding			Rough Wiring			<input type="checkbox"/> Generator(s) <input type="checkbox"/> Motors			Fixtures Lampholders	
		Floor Ducts Raceways			Service Panel Switchboard			<input type="checkbox"/> Water Htr <input type="checkbox"/> Welder			Signs	
		Service Conduit			Busways Ducts			<input type="checkbox"/> Heaters <input type="checkbox"/> Heat Cable			Electric Mtr. Clearance	
		Temporary Power Pole			Subpanels			<input type="checkbox"/> Duct Htr(s) <input type="checkbox"/> Furnace(s)			FINAL APPROVAL	
<b>BUILDING</b>		Location, Set-backs, Esmt(s)			Exterior Wall Construction			Roof Covering Roof Drainage			Smoke Detector	
		Excavation						Exterior Lath			Demolition (sewer cap)	
		Footings & Reinforcing	<i>7/23/85</i>	<i>[Signature]</i>				<input type="checkbox"/> Interior Lath <input type="checkbox"/> Wallboard				
		Floor Slab			Interior Wall Construction			Fire Wall(s)			Building or Structure	
		Foundation Walls			Columns & Supports			Fireplace Chimney				
		Sub-soil Drain			Crawl Space <input type="checkbox"/> Vent <input type="checkbox"/> Access			Attic <input type="checkbox"/> Vent <input type="checkbox"/> Access				
		Piles			Floor System(s)						FINAL APPROVAL BLDG. DEPT.	
				Roof System			Special Insp Reports Rec'd			Certificate of Occupancy Issued		
<b>ADDITIONAL</b>	<b>INSPECTIONS, CORRECTIONS, ETC.</b>					<b>INSPECTIONS, CORRECTIONS, ETC.</b>						
		<i>7/22/85 Footer along ext. Bldg</i>					<i>9/18/85 Footer &amp; Steel going in</i>					
		<i>8/29/85 All footers &amp; form wall in for main Bldg</i>										
		<i>9/13/85 Footer for Mech Bldg</i>										

OLD  
STRUCTURE

NEW STRUCTURE

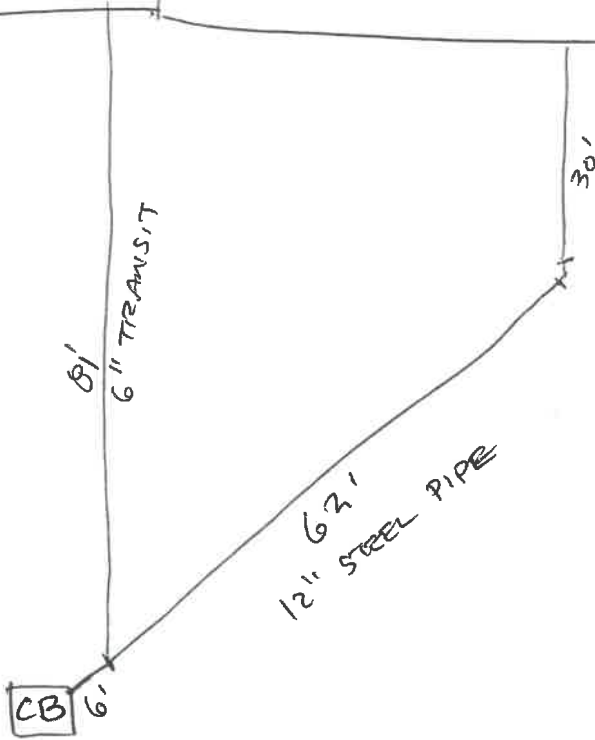

INTERSTAGE COLD STORAGE  
STORM DRAINAGE



# PERMIT

## CITY OF NAPOLEON - BUILDING DEPARTMENT

255 West Riverview Avenue, Napoleon, Ohio 43545 - 419-592-4010

Permit No. 01059 Issued 10JUL85  
date

Job Location 1 Interstate Drive  
address

Lot F Westhoven Industrial Park  
sub-div or legal discript

Issued By Richard G Hayman PER  
building official

Owner Tippmann And Associates  
name tel.

Address 4410 New Hixon Ave Fort Wayne IN

Agent Self 423-2452  
builder-eng.-etc. tel.

Address \_\_\_\_\_

Description of Use Cold Storage S-2

---

Residential \_\_\_\_\_  
no. dwelling units

Commercial \_\_\_\_\_ Industrial I-1

New \_\_\_\_\_ Add'n. 30,104 Alter \_\_\_\_\_ Remodel \_\_\_\_\_

Mixed Occupancy \_\_\_\_\_

Change of Occupancy \_\_\_\_\_

Estimated Cost \$ 1.8 Mila

FEES	BASE	PLUS	TOTAL
<input type="checkbox"/> BUILDING	35.00	361.25	396.25
<input type="checkbox"/> ELECTRICAL	12.00	120.42	132.42
<input type="checkbox"/> PLUMBING			
<input type="checkbox"/> MECHANICAL			
<input type="checkbox"/> DEMOLITION			
<input type="checkbox"/> ZONING			
<input type="checkbox"/> SIGN			
WATER TAP			
SEWER TAP			
TEMP. ELECT.			
ADDITIONAL PLAN REVIEW	Struct. _____ hrs	Elect. _____ hrs	
TOTAL FEES.....			528.67
LESS MIN. FEES PAID _____ <small>date</small>			-0-
BALANCE DUE.....			528.67

### ZONING INFORMATION

district <u>I-1 CI</u>	lot dimensions <u>E25a x 289a</u>	area <u>183040.13 1</u>	front yd <u>60</u>	side yds <u>10</u>	rear yd <u>10</u>
max hgt <u>40</u>	no pkg spaces	no ldg spaces	max cover <u>111,024.08</u>	petition or appeal req'd <u>BZA 5-85</u>	date appr <u>02JUL85</u>

### WORK INFORMATION:

Size: Length 159-4" Width 189' Stories 1 Ground Floor Area 30,104

Height 28 Building Volume (for demo. permit) \_\_\_\_\_ cu. ft.

Electrical: Entire brief description \_\_\_\_\_

Plumbing: \_\_\_\_\_ brief description \_\_\_\_\_

Mechanical: \_\_\_\_\_ brief description \_\_\_\_\_

Sign: \_\_\_\_\_ Dimensions \_\_\_\_\_ Sign Area \_\_\_\_\_

Additional Information: \_\_\_\_\_

JUL 10 1985

CITY OF NAPOLEON

Date \_\_\_\_\_ Applicant Signature \_\_\_\_\_  
owner-agent



CITY OF NAPOLEON  
APPLICATION FOR COMMERCIAL AND INDUSTRIAL BUILDING PERMIT

The undersigned hereby makes application for construction, installation or alteration work as herein specified, agreeing to do all such work in strict accordance with the City of Napoleon's Codes and the Ohio Basic Building Code, the National Electric Code, the Ohio Mechanical Code and the Ohio Energy Code. This application shall be accompanied by the following: TWO COMPLETE SETS OF PLANS including: Elevations, Floor Plans, Cross Sections and Plot Plan. If addition or remodeling, show all existing structures and their size and location. All Plans shall be drawn to scale. Application for Electrical, Plumbing and Heating Permit. Application shall be filed for Plumbing but applicant shall get permit from the State of Ohio. Permit shall be filed with this application.

LOCATION OF PROJECT 1 INTERSTATE DRIVE COST OF PROJECT \$ 1.8 Million

OWNERS NAME AND ADDRESS Tippmann & Associates

GENERAL CONTRACTOR Tippmann Refrigeration. TELEPHONE 219 423-2452  
ADDRESS 4410 New Haven Ave Fort Wayne, IN 46803

SUBCONTRACTORS AND ADDRESS'S

- Electrical \_\_\_\_\_
- Plumbing \_\_\_\_\_
- Heating \_\_\_\_\_
- Others \_\_\_\_\_

WORK INFORMATION

Commercial \_\_\_\_\_ Industrial \_\_\_\_\_ New Construction \_\_\_\_\_ Addition  Remodel \_\_\_\_\_  
Principle Building \_\_\_\_\_ Accessory Building \_\_\_\_\_ Setbacks: Front \_\_\_\_\_ Side \_\_\_\_\_ Rear \_\_\_\_\_

OBBC USE GROUP CLASSIFICATION -CHECK PROPER USE GROUP

A1A	A1B	A2	A3	A4	A5	B	F	H	I1	I2	M	R1	R2	R3	S1	S2	T

BRIEF DESCRIPTION OF THE WORK 30,000 + Sq. FT ADDITION FOR Cold STORAGE OF Frozen Food Products.

BUILDING SIZE: Length 159'4" Width 189' No. of Stories (1) Height 28'

CONSTRUCTION TYPE

1A	1B	2A	2B	2C	3A	3B	3C	4A	4B
				X					

SQUARE FEET BASEMENT - 0 - N/A -  
1st FLOOR 30,104 SQ FT  
2nd FLOOR N/A

BUILDING DEPT USE: PERMIT FEES

- Structural stamped drawings \$35.00 plus \$1.20 per 100 sq. ft. all floors. \$396.25
- Structural unstamped drawings \$35.00 per hr. review plus \$1.75 per 100 Sq. ft. all floors. \$ \_\_\_\_\_
- Electrical Stamped Drawings \$12.00 plus \$.40 per 100 sq.ft. all floors. \$132.42
- Electrical unstamped drawings \$35.00 per hr. plus \$.55 per 100 sq. ft. all floors. \$528.67
- Heating included in structural.

I hereby certify that the proposed work is authorized by the owner to record and that I have been authorized by the owner to make this application as his agent and we agree to conform to all applicable laws of this jurisdiction.

Date 7-10-85 Signature of Applicant John J. McCarthy

1059  
\$528.67

